

HSF

NOTES:

- 1.Current Rating:2A Max (only one pin) ;
- 2.Voltage Rating:175V DC;
- 3.Contact Resistance:30mΩ Max;
- 4.Withstand Voltage:675V AC;
- 5.Insulation Resistance:5000MΩ Min;
- 6.Operating Temperature: -55°C to +125°C;
- 7.Insulator Material: LCP,G.F,UL94V-0,BK;
- 8.Contact Material:Copper Alloy;
- 9.Contact plating:
Au on contact area (See ordering information),
100μ" Matte TIN on solder area,
50μ" Nickel underplating overall;
- 10.Recommended process:
Wavesolder,Peak temperature:260±5°C, 5s ;

Ordering Information

37 2 0 X- P M XXX XXX XX X XX

OPTIONS

- 1=A
 - 2=LC
 - 3=FL
 - P=PLUG
 - M=180° SMT
- WCON INTERNAL CODE
- PACKAGING
A=VACUUM BOX
R=TAPE&REEL

No OF POSITIONS

- 060=60PIN
- 120=120PIN
- 180=180PIN
- 240=240PIN
- 300=300PIN

LEAD STYLE

- 042=4.26
- 072=7.26

- PLATING
- W1=SEL.3U"GOLD/MATTE SN
 - W3=SEL.10U"GOLD/MATTE SN
 - W5=SEL.30U"GOLD/MATTE SN

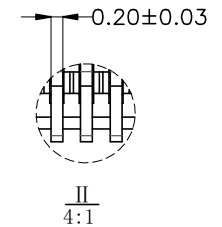
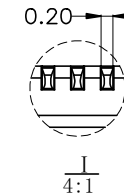
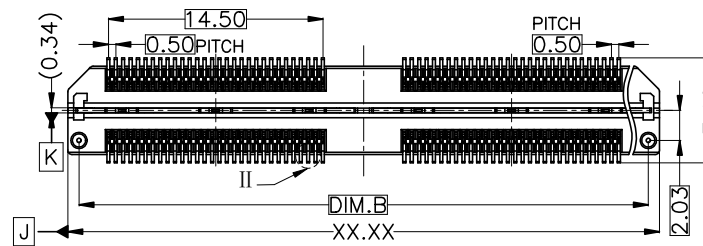
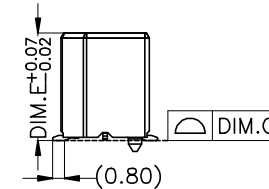
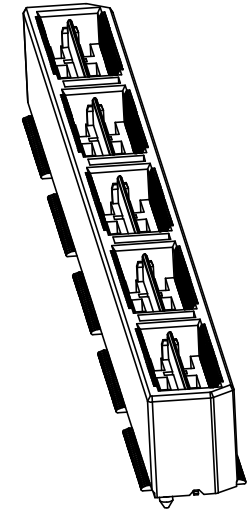
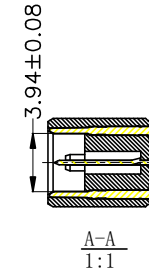
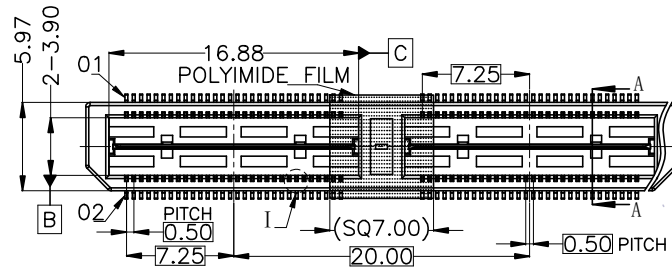

REV	DATE	MODIFICATION DESCRIPTION	CHANGE	OPERATION	DRAW	DATE	SCALE	Fit	PART NO.
				x.x ±0.40	Abt Chen	2022.04.06	UNIT	mm	RH-37202-PMXXX-042XXX01
				x.xx ±0.25	CHECK	DATE	SIZE	A4	TITeE: - -
				x.xxx ±0.15	APPROVE	DATE	SHEET	1/4	0.5mmB0 TO B0 PLUG SMT, ASSEMBLY
				Angle ± 3'			PROJ.	⌀	Customer NO.
				DIM TOL					



<https://www.renhotec.com>

info@renhotec.com